

D 155 Kildare

IRENET CONTROL STATION

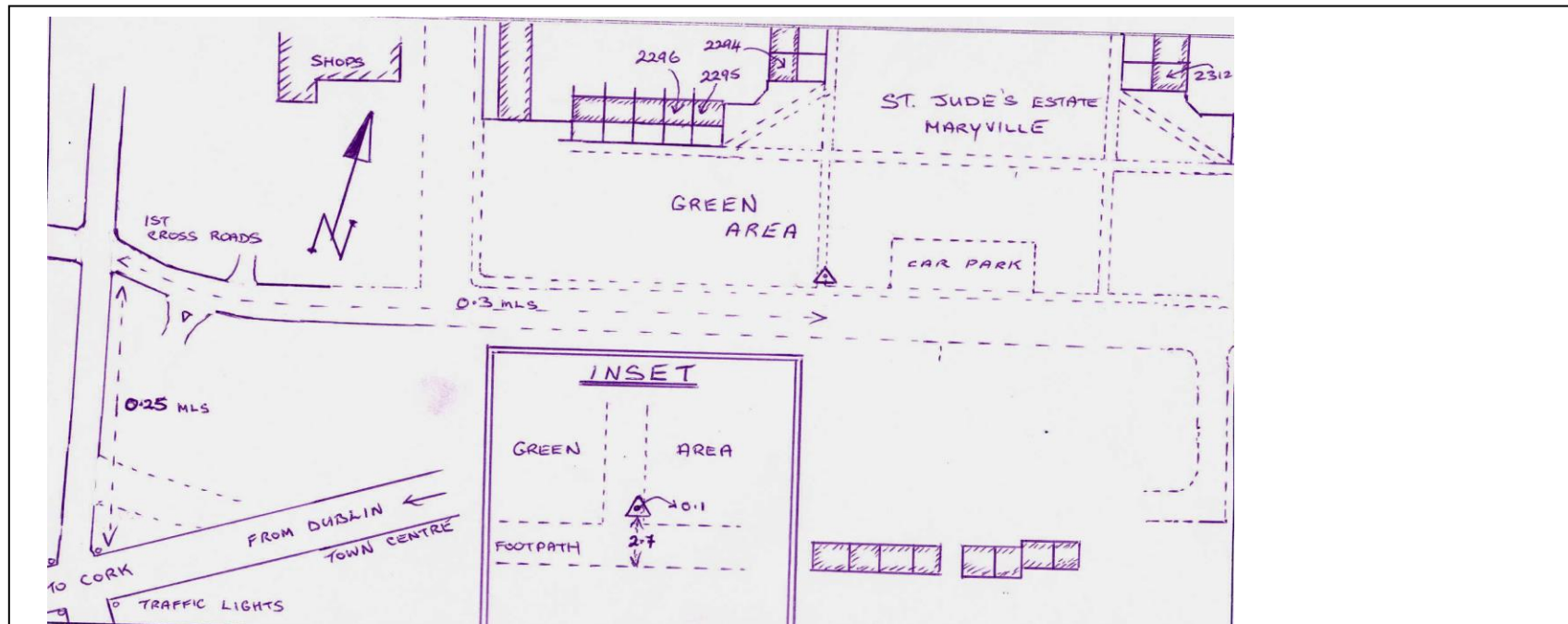

IRENET-95 COORDS. (ETRF89)

LAT 53° 09' 38.12859"
 LONG. -06° 54' 08.36028"
 ELLIP. HT. 160.7143

ITM COORDINATES

Easting: 673406.829
 Northing: 712795.949
 Ht. (MSL mts)

IRISH GRID COORDINATES

Easting: 273472.071
 Northing: 212764.748
 Ht. (MSL mts) 104.527

WRITTEN DESCRIPTION

This station consists of a small brass rivet set in concrete footpath at St. Jude's estate on the back road to Newbridge from Kildare. Approached by turning right at the traffic lights in town center when traveling from Dublin, then proceed 0/25 mls and turn right at the first cross roads, and continue 0.3mls until St. Judes estate, Maryville is reached on the left, and the rivet is on footpath adjacent to small car park.

Note: All measurements shown are in metres. Sketch is not to scale.

GEODETIC SURVEYOR :

DATE: 1995