

IRENET CONTROL STATION D046 SLIGO

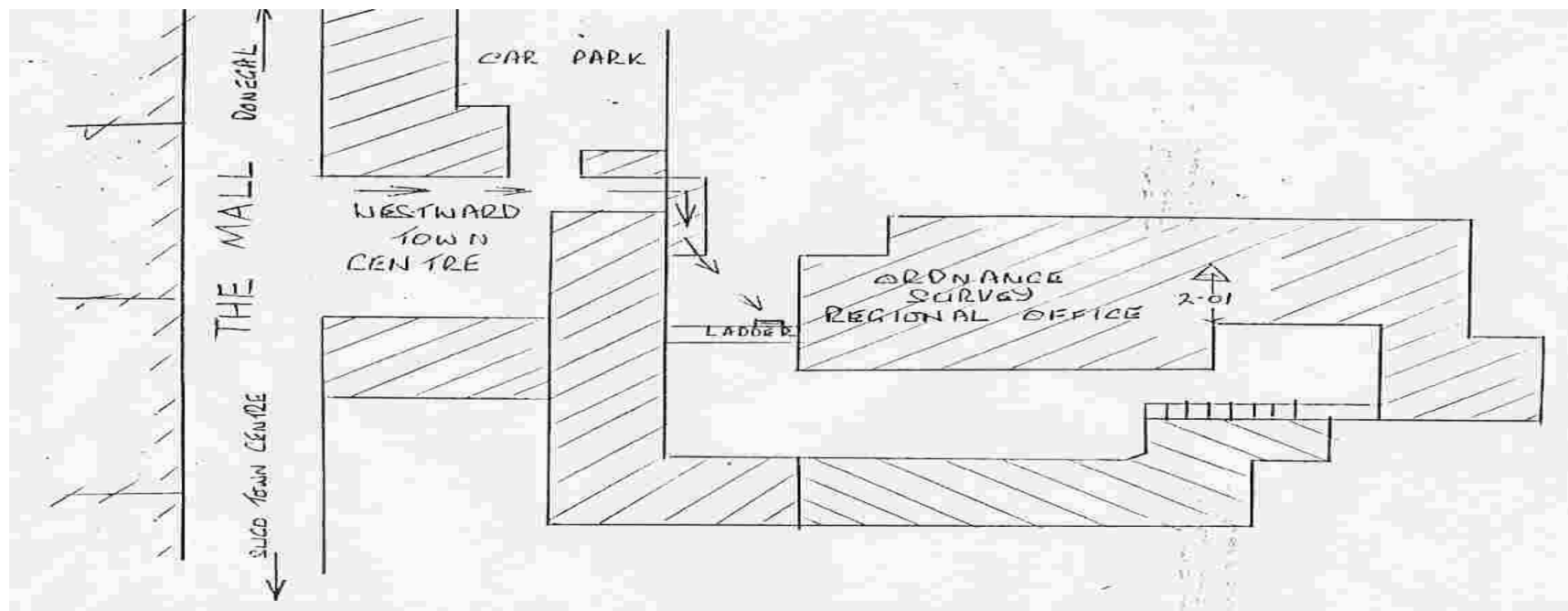

IRENET-95 COORDS. (ETRF89)

LAT 54° 16' 19.66985
 LONG. 08° 28' 15.51260
 ELLIP. HT. 72.9828

ITM COORDINATES

Easting: 569322.817
 Northing: 836027.232
 Ht. (MSL mts)

IRISH GRID COORDINATES

Easting: 169364.750
 Northing: 336022.088
 Ht. (MSL mts) 15.217 (Sp. Lev)

WRITTEN DESCRIPTION

This station consists of a pillar plate with bung inverted set in concrete block on highest roof of Ordnance Survey regional office in Sligo. This office is located in the Westward town center in Sligo town. Access to the point is gained via a ladder that is available from the caretaker.

GEODETIC SURVEYOR :

DATE: