

IRENET CONTROL STATION D131 ROSCREA

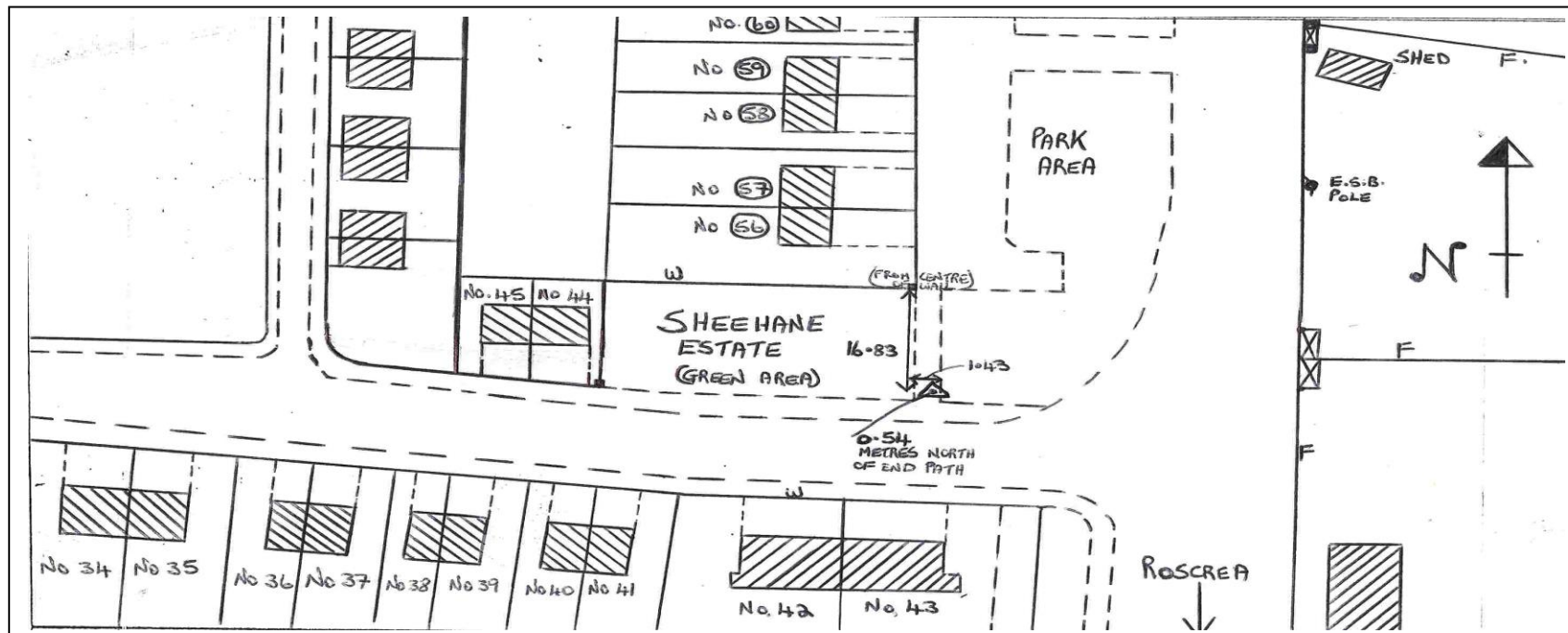

IRENET-95 COORDS. (ETRF89)

LAT 52° 57' 45.18513
 LONG. 07° 48' 08.41910
 ELLIP. HT. 165.2975

ITM COORDINATES

Easting: 613279.517
 Northing: 690216.067
 Ht. (MSL mts)

IRISH GRID COORDINATES

Easting: 213331.700
 Northing: 190179.778
 Ht. (MSL mts) 108.519 (Sp. Level)

WRITTEN DESCRIPTION

This station consists of a brass rivet set in concrete footpath 0.54 metres north from junction of paths at entrance to Sheehane estate. From Roscrea town centre take the road to Kinnitty for approx 100 metres. Take first left and travel approx. 0.35 miles to Sheehane estate on west side of road.

Note: All measurements shown are in metres. Sketch is not to scale.

GEODETIC SURVEYOR :

DATE: