

IRENET CONTROL STATION D104 MALLOW

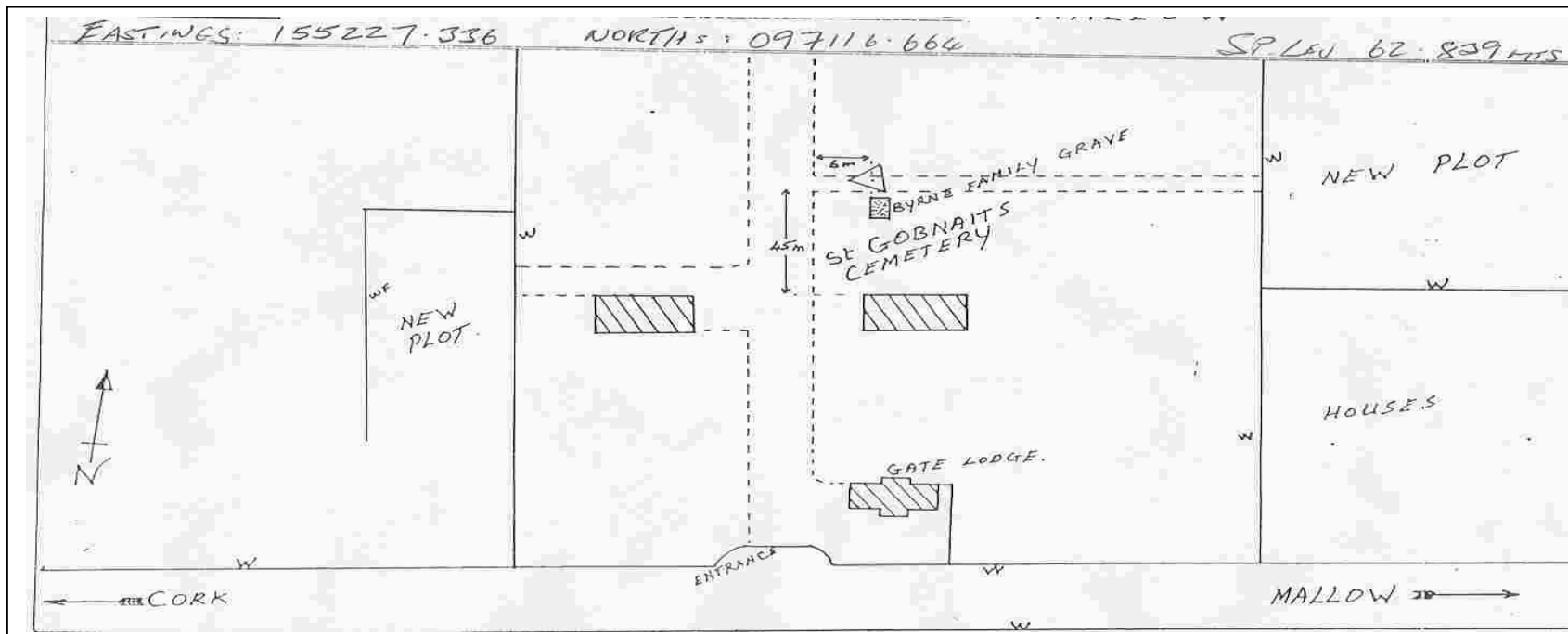

IRENET-95 COORDS. (ETRF89)

LAT 52° 07' 28.62427
 LONG. 08° 39' 16.00142
 ELLIP. HT. 120.2001

ITM COORDINATES

Easting: 555187.245
 Northing: 597173.308
 Ht. (MSL mts)

IRISH GRID COORDINATES

Easting: 155227.336
 Northing: 097116.664
 Ht. (MSL mts) 62.839 (Sp. Level)

WRITTEN DESCRIPTION

This station consists of a brass rivet situated on the north edge of footpath on straight of west side of grave surround. (John Byrne & family).

Note: All measurements shown are in metres. Sketch is not to scale.

GEODETIC SURVEYOR :

DATE: