

IRENET CONTROL STATION D085 LOUGHREA

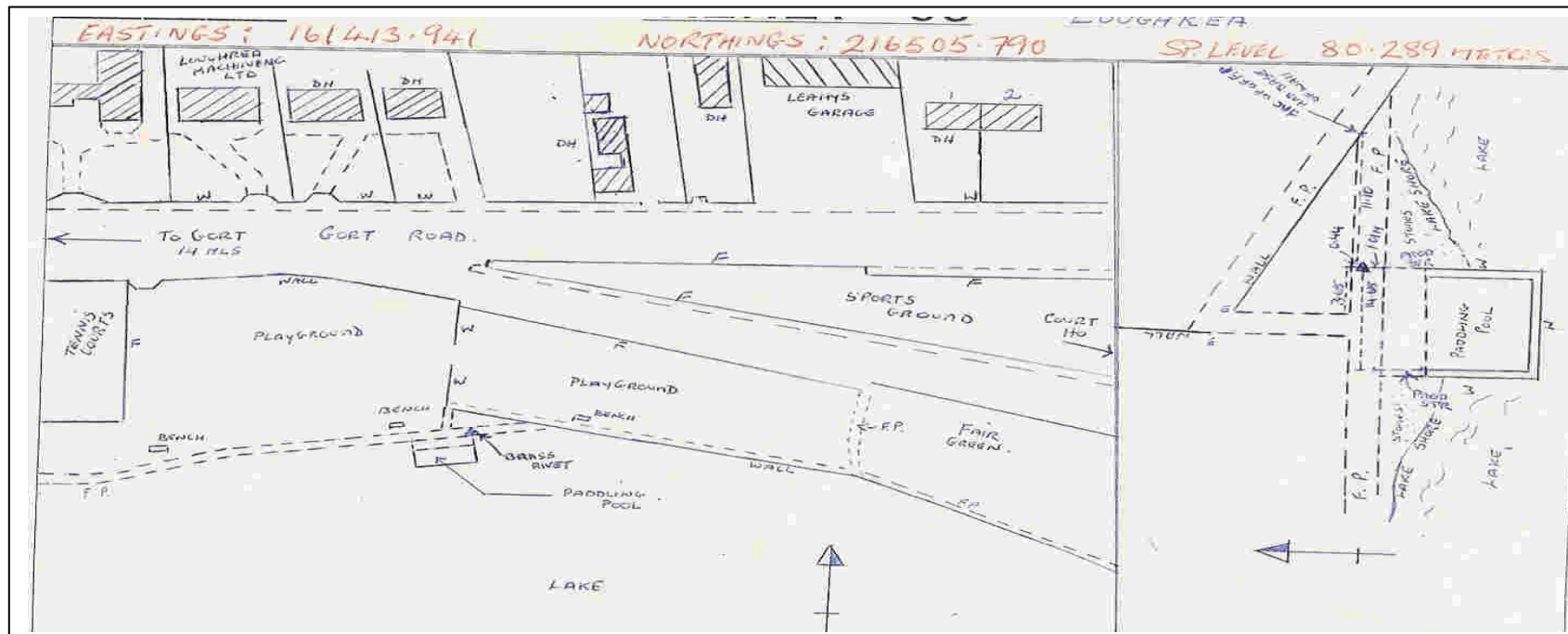

IRENET-95 COORDS. (ETRF89)

LAT 53° 11' 52.31404
 LONG. 08° 34' 41.15987
 ELLIP. HT. 137.6435

ITM COORDINATES

Easting: 561372.779
 Northing: 716536.631
 Ht. (MSL mts)

IRISH GRID COORDINATES

Easting: 161413.941
 Northing: 216505.790
 Ht. (MSL mts) 80.289 (Sp. Level)

WRITTEN DESCRIPTION

This station consists of a brass rivet set in a foot path running along the shoreline of Loughrea. The rivet is set in the footpath along the N.E. straight of a paddling pool wall.

Note: All measurements shown are in metres. Sketch is not to scale.

GEODETIC SURVEYOR :

DATE: