

## D 165 Carrick on Suir IRENET CONTROL STATION

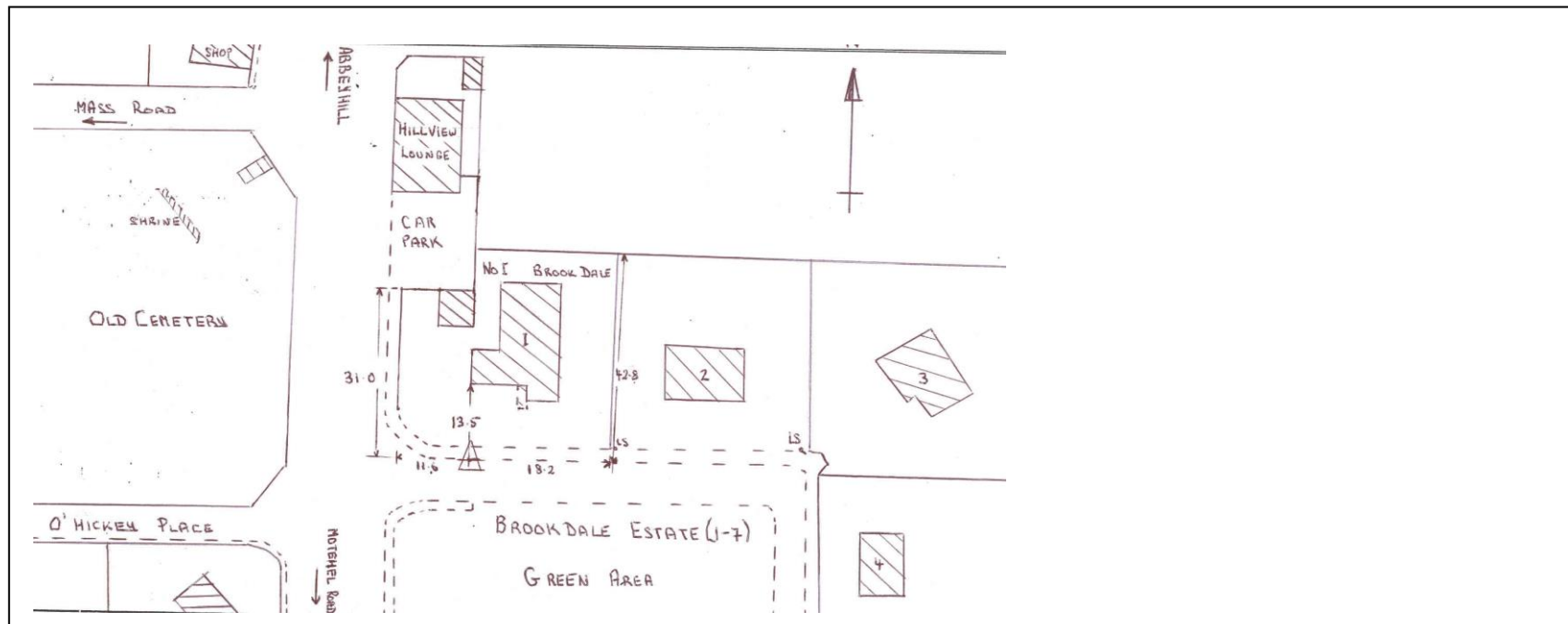

### **IRENET-95 COORDS. (ETRF89)**

LAT 52° 20' 33.85274"  
 LONG. -07° 24' 57.02050"  
 ELLIP. HT. 72.7515

### **ITM COORDINATES**

Easting: 639804.566  
 Northing: 621398.056  
 Ht. (MSL mts)

### **IRISH GRID COORDINATES**

Easting: 239862.809  
 Northing: 121346.591  
 Ht. (MSL mts) 16.438

### **WRITTEN DESCRIPTION**

This station consists of a brass rivet set at outer edge of footpath, at entrance to Brookdale Estate. It is 13.5 mts out from straight of house.

**Note:** All measurements shown are in metres. Sketch is not to scale.

**GEODETIC SURVEYOR :**

**DATE: 1995**